

These are directions for installing the Quadzilla flasher program on a Windows 7 or Windows 10 machine.

Put the unzipped Quadzilla folder in your C:\ directory so it should look like c:\QuadFlashInt\

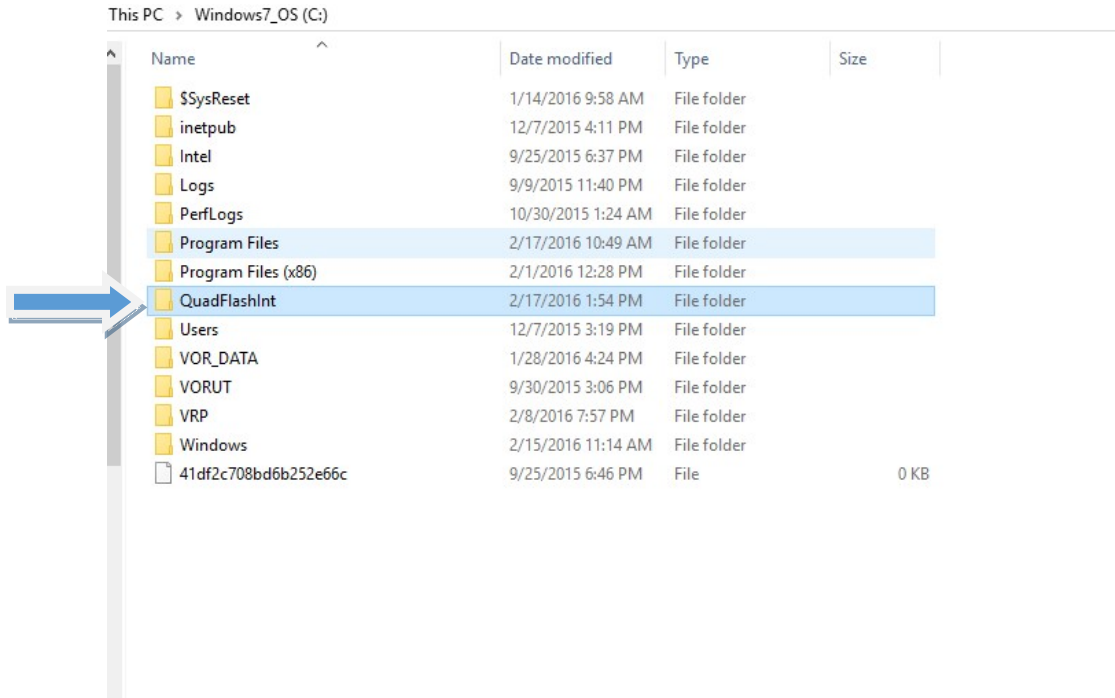

Double Click the newly Created “QuadFlashInt” folder to open it.

With the QuadFlashInt folder open you will see 2 shortcuts, Step1 which will reboot your machine, and Step2 which will prompt the user to install the driver for the Quadzilla Tuner.

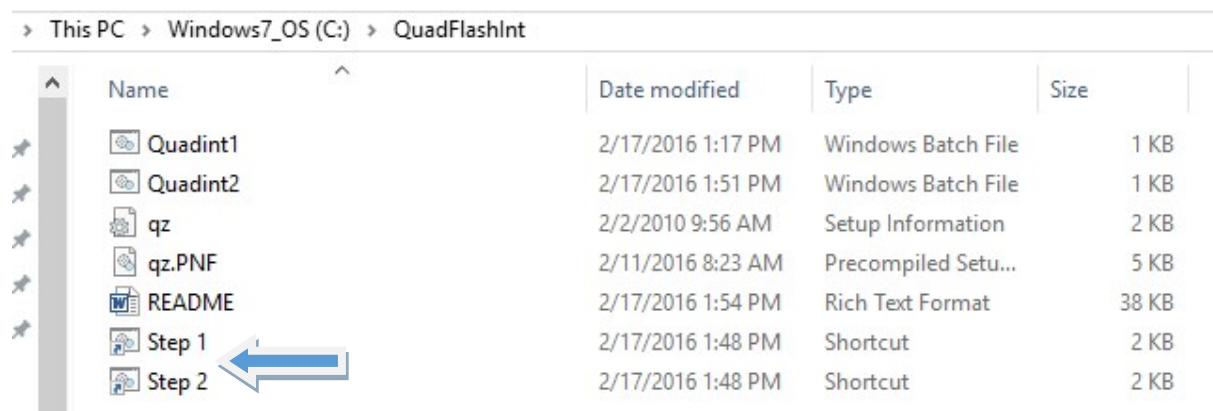

Step 1.

ENSURE you Save and Close all documents and Programs that are open, then double Click the Step 1 Shortcut.

1. Press the Windows key + R to bring up the Run box. Type **shutdown /r /o** and hit Enter.
2. Windows informs you that you are about to be signed off. Click **Close**.
3. Once your Computer has rebooted you will need to choose the **Troubleshoot** option.

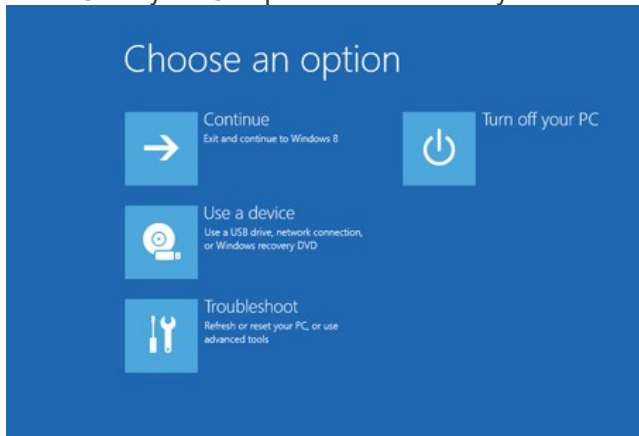

4. Then head into **Advanced options**.

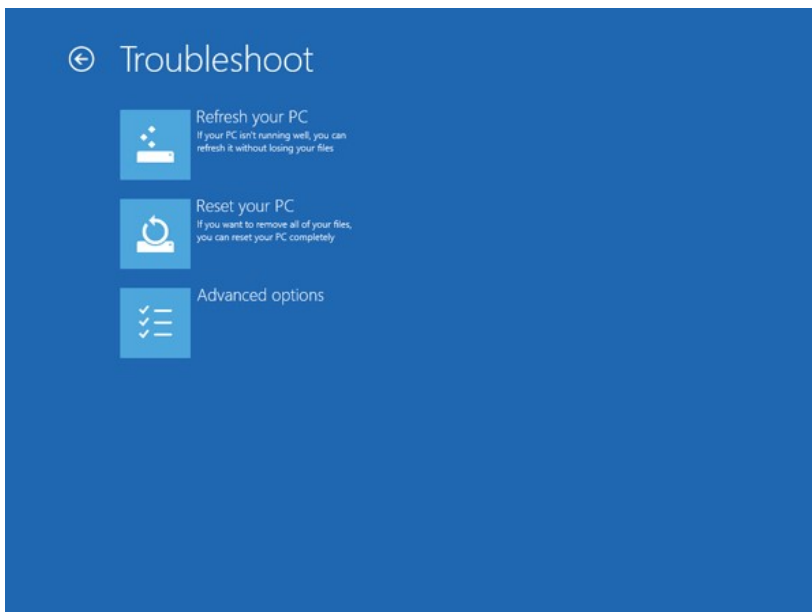

5. In the Advanced Options window, choose **Startup Settings**.

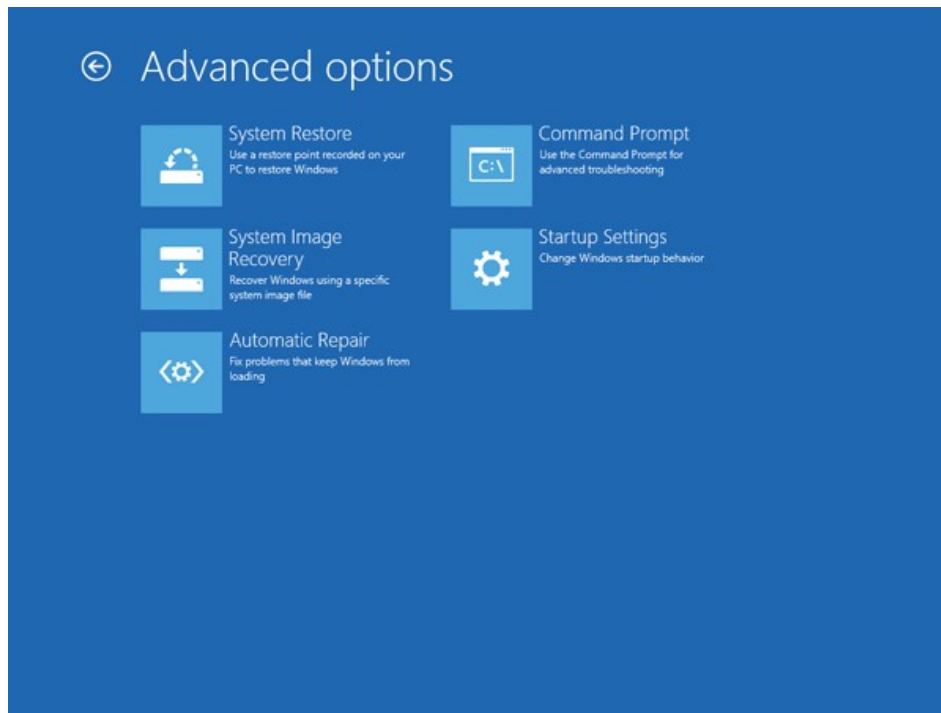

6. Click the **Restart** button on the Startup Settings screen to reboot your computer again.

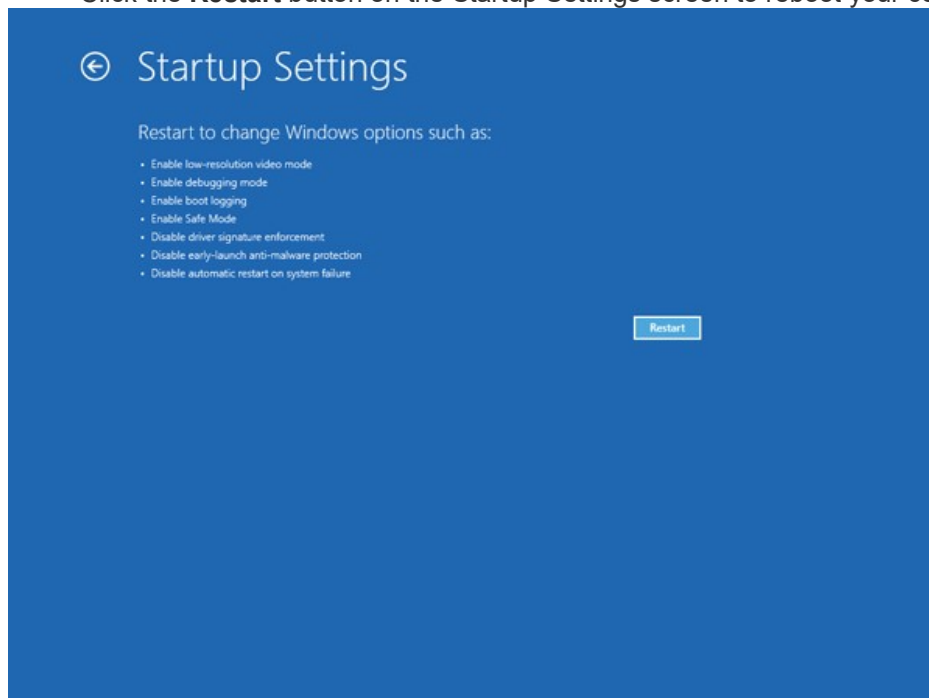

7. After restart in Startup Settings windows, press the F7 key on your keyboard to select “**Disable driver signature enforcement**”.

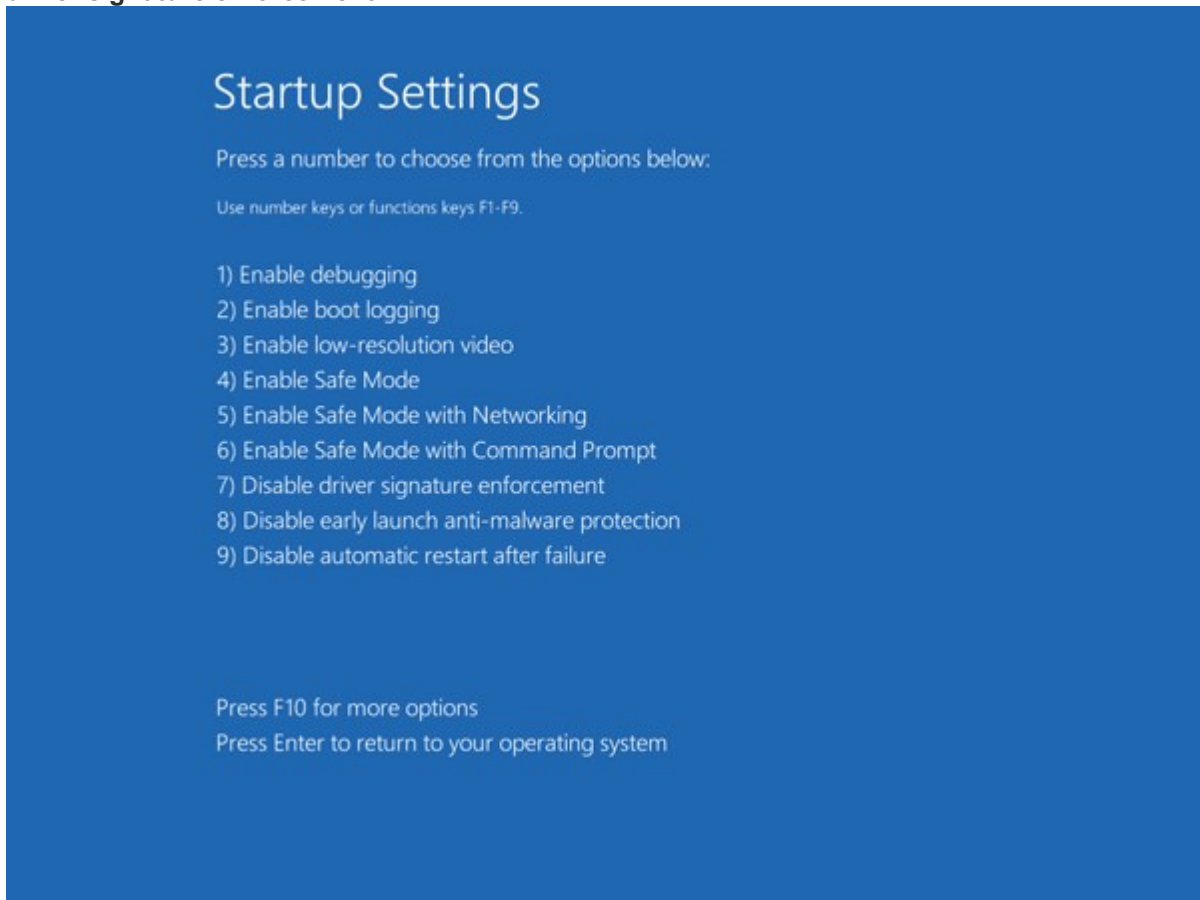

Once your Computer Reboots Reopen the README File and Continue with Step 2.

Step 2.

-Reopen the QuadFlashInt Folder and Right Click Step 2, Select "Run as Admin" Plug in your Quadzilla to your computer

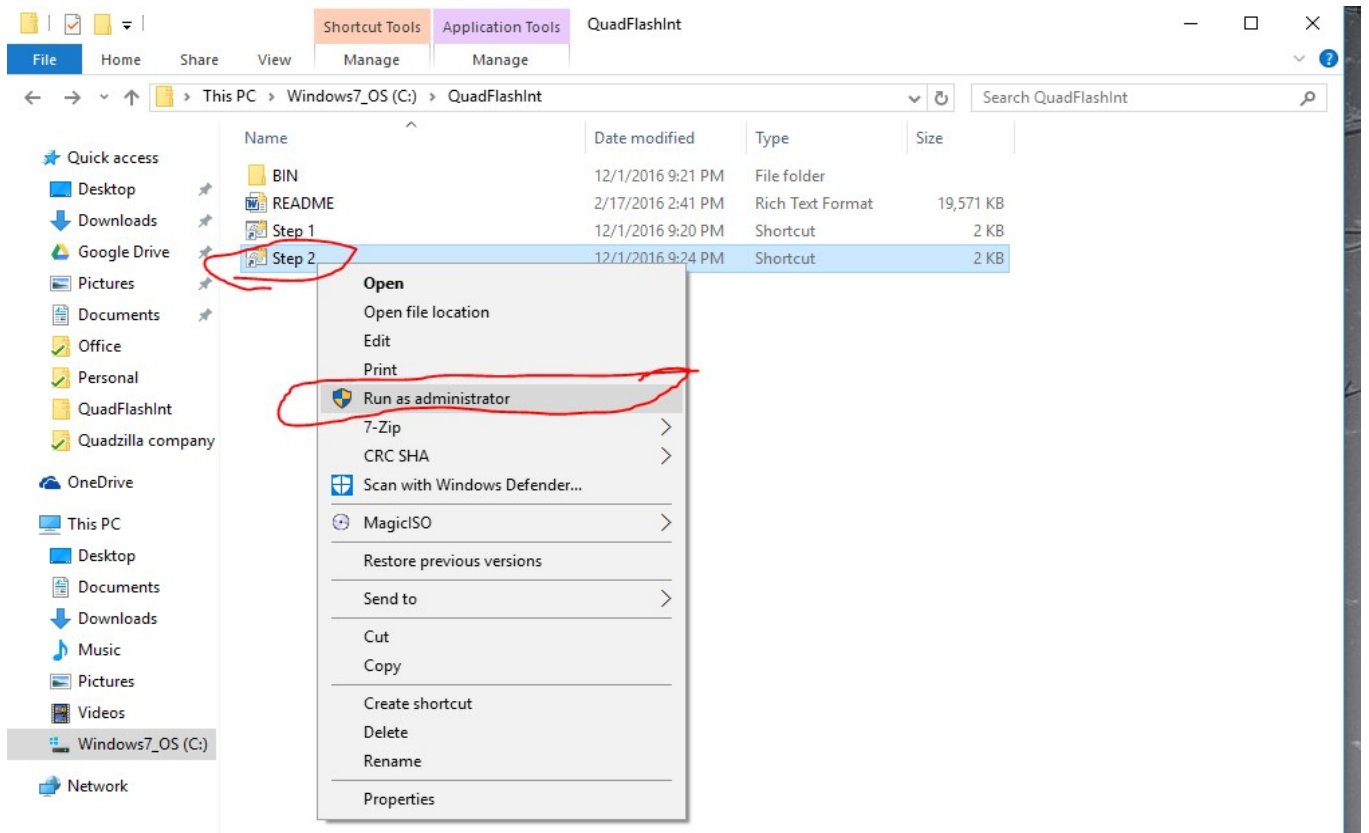

-A black Box will come up, allow for the countdown timer complete

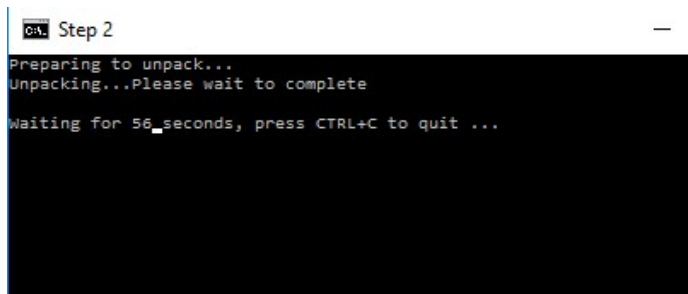

-The Program will copy the driver into the needed place and then update the Driver. You will be prompted to install the unsigned Driver, Choose “install this driver software anyways”

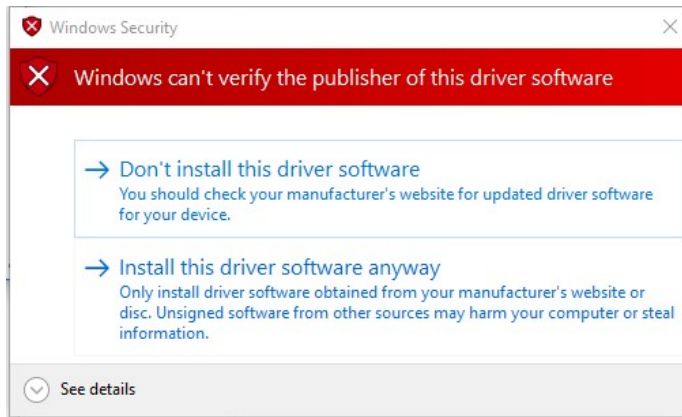

-The driver will install and the setup is complete, Hit Any Key to close the program.

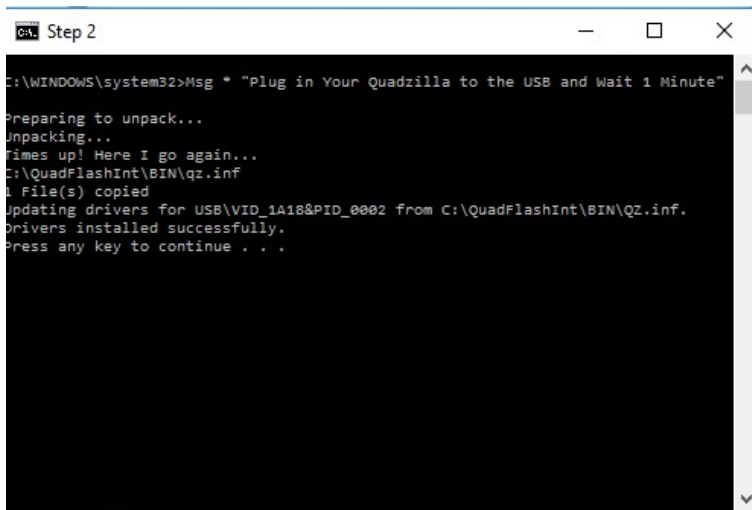

-Unplug your Quadzilla and reboot your computer

Step 3.

-Launch the Quadzilla tune you want to load to your Quadzilla Tuner.

-Next plug in your Quadzilla tuner.

-Verify that when you click “Get information from module” it finds your tuner.

-Lastly Click "Update Module" to flash your tuner with the new tune.

